

VIAIR[®]
Your Vital Air Source

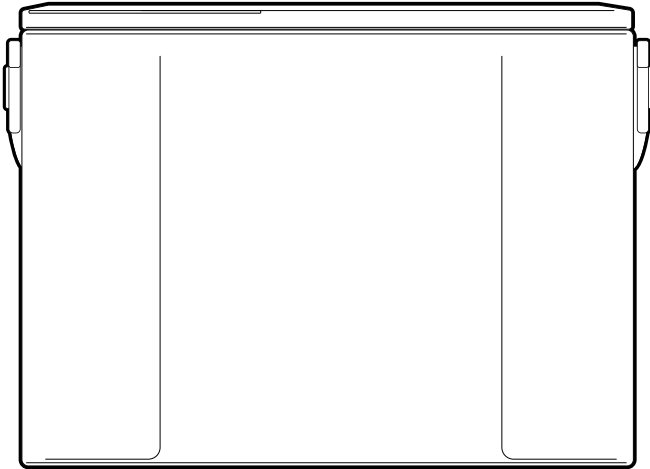

00071 – TLC LITE COMPRESSOR KIT



IMPORTANT:

It is essential that you and any other operator of this product read and understand the contents of this manual before installing and using this product.

SAVE THIS MANUAL FOR FUTURE REFERENCE



USER MANUAL

TLC LITE COMPRESSOR KIT

IMPORTANT SAFETY INSTRUCTIONS

CAUTION - To reduce risk of electrical shock:

- Do not disassemble or attempt to repair or modify unit while it is still connected to the vehicle.
- Do not use this product in an area where it can fall or be pulled into water or other liquids.
- Do not reach for this product if it has fallen into liquid.
- Use this compressor with 12-Volt DC systems only.
- This product should never be left unattended during use.

WARNING - To prevent injury:

- Close supervision is necessary when this compressor is being used near children. Never allow a child to operate this compressor.
- This compressor will become very HOT during and immediately after use. Do not touch any parts with bare hands, other than the ON/OFF switch during and immediately after use.
- Do not use this product near flames or explosive materials or where aerosol products are being used.
- Do not operate this product where oxygen is being administered.
- Do not pump anything other than atmospheric air.
- Never use this product while sleepy or drowsy.
- Do not use any tools or attachments without first determining maximum air pressure for that tool or attachment.
- Never point any air nozzle or air sprayer toward another person or any part of the body.
- This air compressor is equipped with an Automatic Reset Thermal Protector, and can automatically restart after the thermal protector resets. Always cut off power source when thermal protector becomes activated.
- Use only in well ventilated areas.
- After use, always release excess pressure from the coil hose and tank. Turn off the unit and with the inflator still connected to the hose, pull the trigger to release excess pressure.

TLC LITE COMPRESSOR KIT COMPONENTS LIST:

Please familiarize yourself with the components list in this manual before you begin to use your compressor.

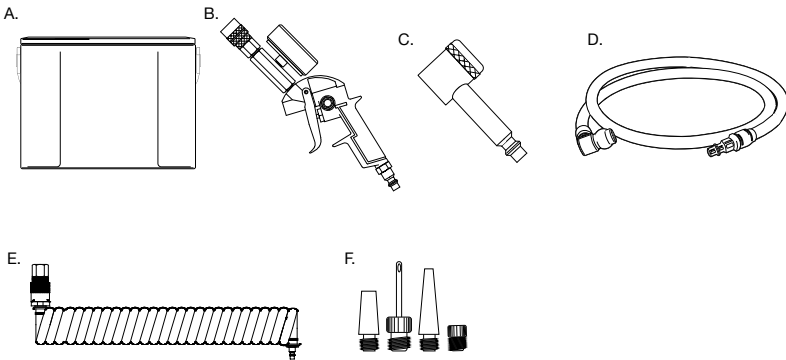

- A. TLC LITE Compressor
- B. TLC Inflator with 120PSI gauge
- C. Rebuildable Presta Head attachment
- D. 90-Degree Twist-on Schrader attachment
- E. 30ft. Inside Braided Coil Hose
- F. Inflation tips kit

TLC LITE COMPRESSOR KIT

OPERATING INSTRUCTIONS:

Your TLC LITE is powered via the Aux-port of your vehicle. To avoid draining your battery and assure the compressor is getting the proper amperage, make sure your vehicle's engine is running during operation, especially if using for a prolonged period of time.

USING THE COMPRESSOR:

The TLC LITE requires a power port rated for 15-Amps. Most automotive cigarette lighter/power ports can handle 15-Amps, however, some vehicles' power ports may have lower amp ratings. Before purchasing and using this unit, inspect the amp draw limitations of your vehicle's power port. Never install fuses featuring amps beyond the original rating of the circuit. Consult your vehicle's manual for further details.

- a. Connect the Coil Hose to the Quick Connect Stud on your TLC LITE.
- b. Connect the TLC Inflator to the other end of the Coil Hose.
- c. Connect the TLC LITE to an Aux-port in your vehicle.
- d. Turn on your TLC LITE by flipping the switch to the ON (I) position.
- e. The compressor will run briefly and automatically shut off when the Coil Hose has been filled to max pressure. The cooling fan in the unit may run continuously, this is normal.
- f. You're now ready to perform your pneumatic tasks!

Important Note: This compressor is moisture & dust resistant, but NOT DIRT OR WATERPROOF. Do not store the compressor in locations where the unit is likely to come in contact with the elements.

USING THE TLC TIRE INFLATOR

1. Connecting the TLC inflator:

Select an inflation attachment and connect it to the TLC Inflator Quick-Connect Coupler. Then, connect the Inflator to an air hose by inserting the Quick-Connect Stud into the air hose coupler.

2. Inflating/Deflating Tires:

To inflate, squeeze the Inflation Trigger by pressing it towards the handle of the inflator, this will allow air to flow into the tire. To deflate, press the Bleeder Valve located on the side of the body, this will release air from the tire.

3. Checking Tire Pressure:

To check tire pressure after inflation/deflation, simply release the Inflation Trigger or the Bleeder Valve. This will allow the needle in the gauge to settle and show the accurate pressure reading. You can also check tire pressure by simply connecting the TLC Inflator to a tire valve stem.

4. Storage:

Always store the TLC Inflator in the carry bag provided to protect it from impact or damage.

WARNING:

- Never operate at any pressure exceeding the max reading on the gauge.
- Use caution when attaching or removing air chuck from valve stems.
- Always ensure that tire valve stems are tight before inflating.
- Never inflate any tire or other inflatable past its rated pressure to avoid explosion, possible injury or death.

WARNING: Not intended for use with regular portable compressors (units meant to be operated with an open-ended air chuck). The TLC Inflator is equipped with a close-ended quick coupler (will hold pressure back).

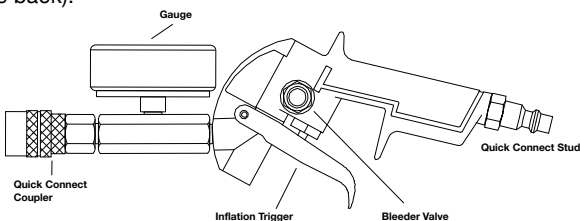

*Tolerance: $\pm 3\%$

TLC LITE COMPRESSOR KIT

REBUILDABLE PRESTA HEAD

Over time, tubeless sealant can clog the internals of the Inflator and make it hard to setup your tires. That's why we designed the Presta Head attachment to be easily rebuildable, so you can clean it periodically and maintain maximum performance. Refer to the diagram below for assembly instructions.

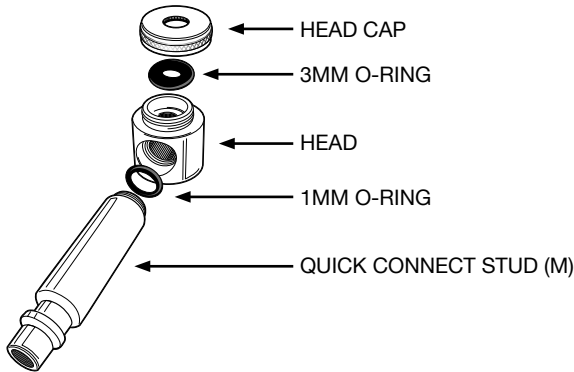

COMPRESSOR MAINTENANCE & REPAIRS

- Drain Coil Hose and tank after each use.
- Replace compressor air filter element periodically. Replacement frequency depends on operating frequency and operating environment. For frequent use in dusty environment, we recommend that you replace air filter element at least once a month.
- Regularly clean dust and dirt from compressor cooling fins and/or motor housing.
- Your air compressor is equipped with a permanently lubricated, maintenance-free motor. Never try to lubricate the compressor.
- All repairs should be performed by Manufacturer or Manufacturer's Authorized Service Agencies only.
- For complete information regarding VIAIR Warranty, please visit: www.viaircorp.com/warranty

SPECIFICATIONS:

00071 – TLC LITE COMPRESSOR KIT: (CE Certified)

Part Number:	00071 / TLC LITE
Voltage:	12-Volts
Max. Amp Draw:	13-Amps
Recommended Fuse:	15-Amps
Motor Type:	Oil-less, Permanent Magnetic
Max. Working Pressure:	105 PSI *
Max. Duty Cycle (@ 72°F & 100 PSI):	10%
Minutes On/Off (@72°F & 100 PSI):	6 On / 54 Off
Max. Ambient Temperature:	158°F
Min. Ambient Temperature:	-40°F
Auto. Reset Thermal Protection:	Yes

* Do not exceed compressor's max working pressure to prevent damage to the compressor.

TLC LITE COMPRESSOR KIT

PERFORMANCE DATA

PSI	CFM	A	BAR	LPM	A
0	1.30	7	0	43.5	7
10	1.00	9	1.0	28.0	9
20	0.95	10	2.0	25.5	11
30	0.90	11	3.0	22.7	11
40	0.85	11	4.0	20.7	12
50	0.77	12	5.0	18.3	12
60	0.72	12	6.0	16.3	12
70	0.65	12	7.0	13.7	12
80	0.60	12	8.0	11.7	12
90	0.54	12	9.0	10.0	11
100	0.48	12			

TLC LITE COMPRESSOR KIT

ABOUT COMPRESSOR DUTY CYCLE:

Duty cycle refers to the amount of time a compressor can be operated in a given time period at 100 PSI, and a standard ambient temperature of 72° F. It is commonly expressed in percentage format: $\text{Compressor on time} \div (\text{on time} + \text{off time}) = \text{Duty Cycle \%}$.

ONE-HOUR DUTY CYCLE

(100 PSI @ 72°F)

9%
10%
15%
20%
25%
30%
33%
50%
100%

MINUTES ON / MINUTES OFF

5 Min. On / 55 Min. Off
6 Min. On / 54 Min. Off
9 Min. On / 51 Min. Off
12 Min. On / 48 Min. Off
15 Min. On / 45 Min. Off
18 Min. On / 42 Min. Off
20 Min. On / 40 Min. Off
30 Min. On / 30 Min. Off
1 Hour Run Time

NOTE: All compressors, regardless of rated duty cycle, require sufficient rest time in between cycles to allow for partial or complete heat dissipation. Heat dissipation rates may vary depending on ambient temperatures and operating conditions.

ABOUT RATED WORKING PRESSURE:

To ensure trouble free service life of your compressor, always operate compressor within rated working pressure of the compressor. Never use a pressure switch with a higher cut-off pressure than compressor's rated working pressure.

WIRE GAUGE GUIDE 12-VOLT:

Amp Draw	Length of wire from battery to compressor (in feet)			
	5	10	15	20
5	16	16	16	14
10	16	14	12	10
15	16	12	10	10
20	14	10	10	8
25	14	10	8	6
30	12	10	8	6
40	12	8	6	6
50	10	6	6	4
60	10	6	4	4

TLC LITE COMPRESSOR KIT

THIS PAGE INTENTIONALLY LEFT BLANK

USER MANUAL

TLC LITE COMPRESSOR KIT

LIMITED WARRANTY:

VIAIR® Corporation warrants this product, when properly installed and under normal conditions of use, to be free from defects in workmanship and materials for a period of one year from its original date of purchase. To receive warranty service or repair, please contact VIAIR® Corporation.

Returns should be made within one year of the date of purchase, after a Return Goods Authorization (RGA) number has been assigned by VIAIR® Corporation. To obtain RGA, fax a copy of your receipt to (949) 585-0188. For complete warranty details, please visit: www.viaircorp.com/warranty

PLEASE NOTE:

THIS WARRANTY COVERS PRODUCT DEFECTS ONLY; IT DOES NOT COVER INCIDENTAL OR CONSEQUENTIAL DAMAGES AS RESULT OF MISUSE OR ABUSE.

This Manual is proprietary to VIAIR® Corporation and no ownership rights are hereby transferred. No part of the Manual shall be used, reproduced, translated, converted, adapted, stored in a retrieval system, communicated or transmitted by any means, for any commercial purpose, including without limitation, sale, resale, license, rental or lease, without the prior express written consent of VIAIR®.

VIAIR® does not make any representations, warranties or guarantees, express or implied, as to the accuracy or completeness of the Manual. Users must be aware that updates and amendments will be made from time to time to the Manual. It is the user's responsibility to determine whether there have been any such updates or amendments. Neither VIAIR® nor any of its directors, officers, employees or agents shall be liable in contract, tort or in any other manner whatsoever to any person for any loss, damage, injury, liability, cost or expense of any nature, including without limitation incidental, special, direct or consequential damages arising out of or in connection with the use of the Manual.



15 EDELMAN • IRVINE, CA 92618
TEL: (949) 585-0011 • FAX: (949) 585-0188
www.viaircorp.com