



65C Compressor

80 PSI / 1.22 CFM
Max. Amp Draw: 10 Amps
P/N 00065 - 12V CE



The 65C is a geared, light-duty air compressor for smaller pneumatic requirements. It's designed to fill no larger than a 1 gallon tank, has a max working pressure of 90 PSI and comes equipped with a check valve. Mounting hardware is included.

Please Note: Use thread sealant for proper installation. Thread tape is not recommended. Properly sealed, recommended torque for 1/8" is 10 ~ 11 ft. lbs. Recommended torque for 1/4" and 3/8" is 16 ~ 18 ft. lbs.

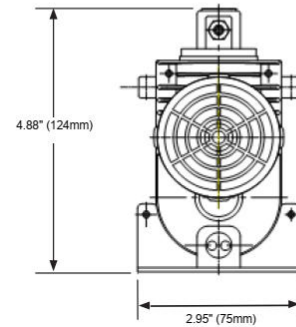
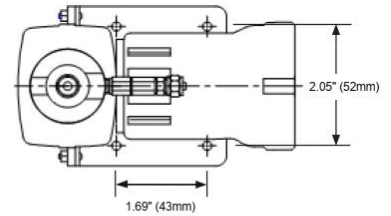
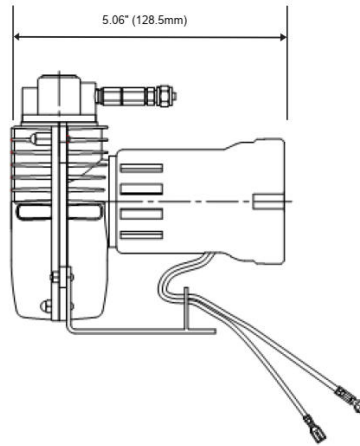

Please contact your representative for pricing.

Included Parts:

- Check Valve
- Vibration Isolators
- Mounting Hardware
- Installation Instructions

Recommended Components:

- 0.5 Gallon Tank - P/N 91005;
- 1.0 Gallon Tank - P/N 91010, 91014

Specifications:

- 12-Volt
- Gear Driven Motor
- Duty Cycle: **15% @ 90 PSI**
- Max. Working Pressure: **90 PSI**
- Max. Air Tank: **1.0 Gallon**
- Min. Ambient Temp: **-40° F**
- Max. Ambient Temp: **158° F**
- Net Weight: **1.6 lbs.**
- Ingress Protection Rating: **IP54**

Dimensions:

(L) 5" x (W) 2.9" x (H) 4.8"

Performance Data					
12-VOLT COMPRESSOR - Supply Voltage 13.8 Volts					
PSI	CFM	A	BAR	LPM	A
0	1.15	6	0	33	6
10	0.59	7	1	17	7
20	0.55	8	2	15	8
30	0.52	8	3	13	9
40	0.48	9	4	12	9
50	0.45	9	5	10	9
60	0.41	9			
70	0.38	9			
80	0.33	10			

Tank Fill Rates	
0.5 GALLON TANK	FILL RATE
0 to 80 PSI	50 sec. (± 05 sec.)
45 to 80 PSI	23 sec. (± 03 sec.)
55 to 80 PSI	19 sec. (± 03 sec.)
1.0 GALLON TANK	FILL RATE
0 to 80 PSI	1 min. 28 sec. (± 05 sec.)
45 to 80 PSI	36 sec. (± 03 sec.)
55 to 80 PSI	33 sec. (± 05 sec.)

Applications include:

