

# 330C-IG Compressor

**150 PSI / 1.06 CFM 12V / 1.16 CFM 24V**

**12V Max. Amp Draw: 16 Amps**

**24V Max. Amp Draw: 9 Amps**

**P/N 33050 - 12V**

**P/N 33058 - 24V**



The 330 IG air compressors are medium-duty, 150 PSI industrial units designed to fill air tanks and feature a head assembly designed for better heat dissipation. They're equipped with a separate stainless steel braided PTFE-lined leader hose and check valve assembly that protects the compressor against high amperage restarts. Available in 12V or 24V.

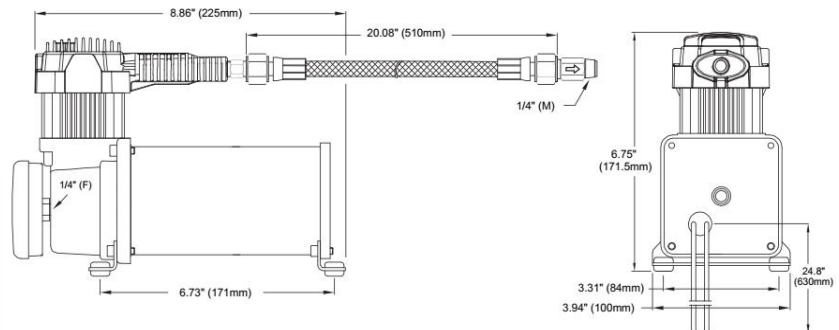

Please contact your representative for pricing.

**Included Parts:**

- Thermal Overload Protector
- Vibration Isolators
- Mounting Hardware
- Heavy Duty 1/4" NPT Check Valve
- Stainless Steel Braided PTFE-lined Leader Hose
- Air Line for Remote Mount Air Filter
- Remote Mount Air Filter Assembly
- (2) Replacement Air Filter Elements
- Installation Instructions

**Recommended Components:**

- 0.5 Gallon Tank - P/N 91005;
- 1.0 Gallon Tank - P/N 91010;
- 2.0 Gallon Tank - P/N 91022;
- 2.5 Gallon Tank - P/N 91025;
- 5.0 Gallon Tank - P/N 91050;
- 12V Relay - P/N 93940, 93977, 93980;
- 24V Relay - P/N 93943, 93979;
- Pressure Switches - P/N 90100, 90101, 90102;
- Pressure Switches with Relay - P/N 90110\*, 90111\*, 90113\*;
- Sealed Pressure Switch - P/N 90217, 90223, 90227;

**Specifications:**

- 12-Volt or 24-Volt
- Permanent Magnetic Motor
- Duty Cycle: 100% @ 100 PSI
- Max. Working Pressure: 150 PSI
- Max. Air Tank Size: 5.0 Gallon
- Max. 12V Amp Draw: 16-Amps
- Max. 24V Amp Draw: 9-Amps
- Ingress Protection Rating: IP67
- Max. Ambient Temp: +158°F
- Min. Ambient Temp: -40°F
- Dimensions: 9" L x 4" W x 6.75" H
- Net Weight: 8.25 lbs.

Performance Data						
12-VOLT COMPRESSOR - Supply Voltage 13.8 Volts						
PSI	CFM	A	BAR	LPM	A	
0	1.06	7	0	30	7	
20	0.9	9	2	24.2	10	
40	0.76	10	4	19.7	11	
60	0.69	11	6	17.7	12	
80	0.64	12	8	15.5	14	
100	0.6	13	10	13	16	

Performance Data						
24-VOLT COMPRESSOR - Supply Voltage 28 Volts						
PSI	CFM	A	BAR	LPM	A	
0	1.16	4	0	33	4	
20	0.95	5	2	25.1	6	
40	0.81	6	4	21.2	7	
60	0.74	7	6	19	7	
80	0.69	7	8	16.5	9	
100	0.63	8	10	13.5	8	

Tank Fill Rates		
2.5 GALLON TANK	12-Volt	24-Volt
0 to 105 PSI	3 min. 40 sec. (± 10 sec.)	3 min. 09 sec. (± 10 sec.)
85 to 105 PSI	50 sec. (± 05 sec.)	45 sec. (± 05 sec.)
0 to 145 PSI	5 min. 45 sec. (± 10 sec.)	5 min. 00 sec. (± 10 sec.)
110 to 145 PSI	1 min. 44 sec. (± 05 sec.)	1 min. 31 sec. (± 05 sec.)
5.0 GALLON TANK	12-Volt	24-Volt
0 to 105 PSI	7 min. 24 sec. (± 15 sec.)	6 min. 20 sec. (± 10 sec.)
85 to 105 PSI	1 min. 40 sec. (± 05 sec.)	1 min. 26 sec. (± 05 sec.)
0 to 145 PSI	12 min. 12 sec. (± 15 sec.)	10 min. 00 sec. (± 15 sec.)
110 to 145 PSI	3 min. 30 sec. (± 10 sec.)	3 min. 12 sec. (± 10 sec.)

\* For 12V Only.

Applications include:

